

QuickZip™ Straight Display

ASSEMBLY INSTRUCTIONS

BOX CONTENTS

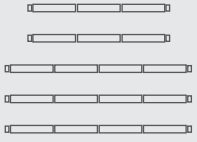

(5) Connected Poles

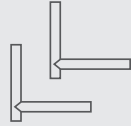

(2) Bottom Corners



(2) Top Corners

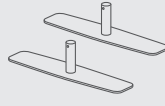

(2) Support Feet



(2) Light Clips

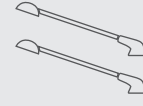

(2) LED Lights
(Optional)



(1) Backdrop Graphic
(Ships Separately)

1

Assemble the Frame

Connect the poles by matching up the numbers. Attach support feet to the bottom of the frame.

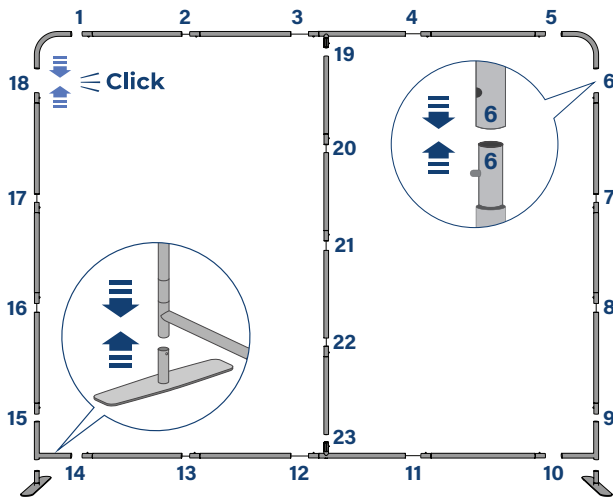

2

Install the Graphic

Carefully pull the graphic print over the frame, ensuring both sides are pulled down at the same time.

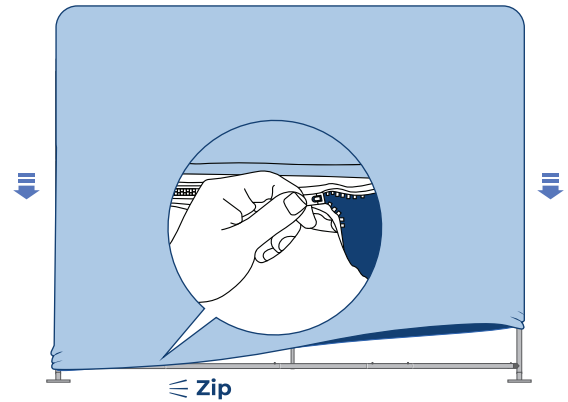

It helps to have a second person to pull the other side simultaneously.

3

Attach LED Lights (Optional)

Attach light clips to the frame (knobs facing back) and tighten until secure. Slide LED lights into the top grooves.

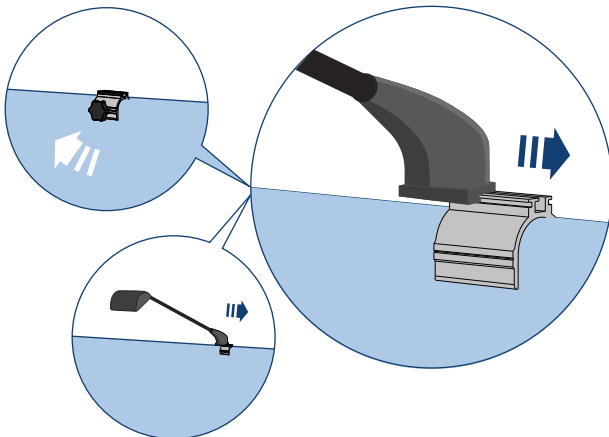

To avoid stripping the light clips, do not twist the knobs too tight.

4

Align the Display

Stand up the frame and shift or wiggle the corners until it's aligned and standing straight. Plug in your lights and your display is ready for action!

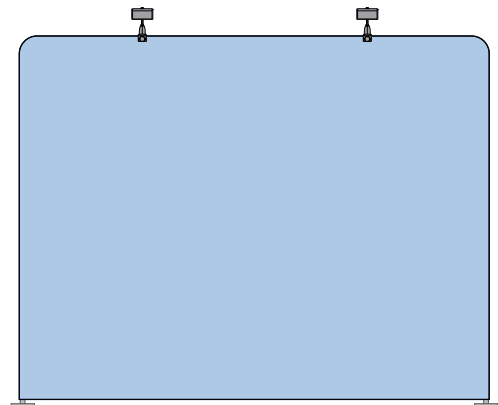

You can adjust the frame alignment by having a person on each side gently shift the top corners until the display stands completely straight.